

SEWER CONNECTION

No. 404

Napoleon, Ohio Date 7/4

received at Otto Meyer

Dollars

Charge for tapping, permit to supply sewer and for work.

Address

Street No. 915 W. MAIN

Sewer size \_\_\_\_\_ Inch

Cost No CHARGE

Type and Kind of Main Sewer \_\_\_\_\_

Location of Main Sewer \_\_\_\_\_

Depth of Main Sewer \_\_\_\_\_

Name OTTO MEYER Size of Tap 4" Date SEPT 11, 71  
 Street 915 W. MAIN Size and Kind of Sewer 4" VCP  
 Old No. \_\_\_\_\_ Location of Sewer 11' FROM CLEANOUT 20' FROM GARAGE CURB  
 New No. \_\_\_\_\_ Depth of Sewer (4") 3 1/2' DEEP  
 Crossover 6" (5 1/2' DEEP) Distance to Curb Stop \_\_\_\_\_

Remarks 4" SEWER 3 1/2' DEEP HAS AN ELBOW AND A 4" VCP WITH ANOTHER ELBOW WITH A REDUCER CONNECTING TO THE 6" CROSSER. THE CROSSOVER IS 5 1/2 FEET DEEP. 4" VCP IS LAID ON A 30° DOWN FROM 4" SEWER

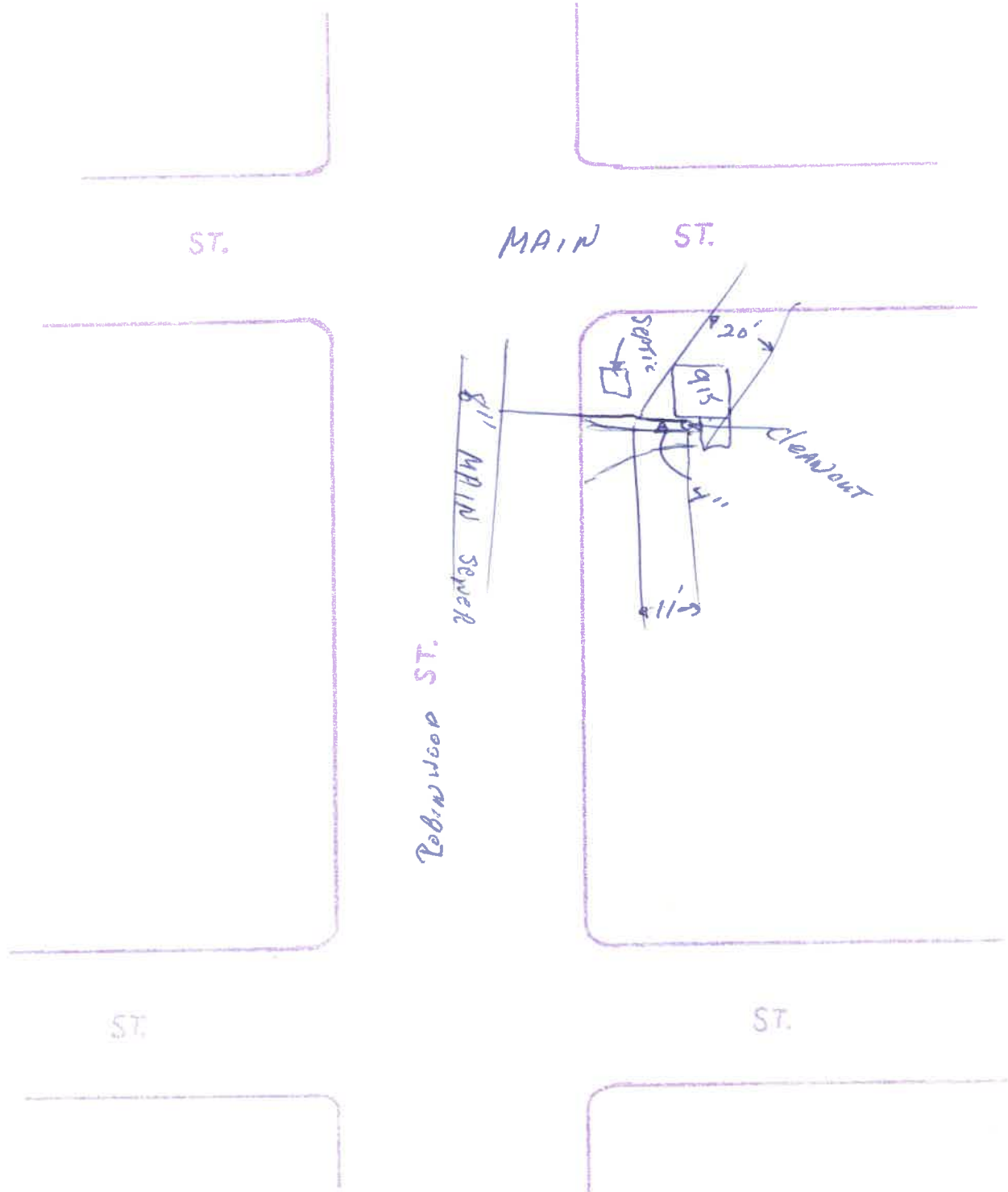

APPLICATION FOR PERMIT TO TAP SEWER

No. 404

Date September 10, 1971

Name Otto Meyer

Address 915 W. Main Napoleon, Ohio

LOCATION OF CONNECTION

Street and Number Same

Lot No. \_\_\_\_\_

Addition \_\_\_\_\_

Date work will start \_\_\_\_\_ (All work must be inspected)

Work will be done by \_\_\_\_\_

I certify that the sewer will be used only as indicated and no other drainage will be connected.

Applicant \_\_\_\_\_

Date 9-10-71

Address \_\_\_\_\_

Permit Fee No charge

Rupert W. Schweinhagen  
Certification by City Clerk

For inspection call 592-5387

Work inspected \_\_\_\_\_

Work completed \_\_\_\_\_

Remarks \_\_\_\_\_

\_\_\_\_\_  
\_\_\_\_\_  
\_\_\_\_\_  
\_\_\_\_\_  
\_\_\_\_\_



APPLICATION FOR PERMIT TO TAP SEWER

No. 404

Date September 10, 1971

Name Otto Meyer

Address 915 W. Main Napoleon, Ohio

LOCATION OF CONNECTION

Street and Number Same

Lot No. \_\_\_\_\_ Addition \_\_\_\_\_

Date work will start \_\_\_\_\_ (All work must be inspected)

Work will be done by \_\_\_\_\_

I certify that the sewer will be used only as indicated and no other drainage will be connected.

Applicant \_\_\_\_\_

Date 9-10-71

Address \_\_\_\_\_

Permit Fee No charge Duput W. Schweinhagen  
Certification by City Clerk

For inspection call 592-5387

Work inspected \_\_\_\_\_

Work completed \_\_\_\_\_

Remarks \_\_\_\_\_

\_\_\_\_\_  
\_\_\_\_\_  
\_\_\_\_\_  
\_\_\_\_\_  
\_\_\_\_\_

